



PROJECT: GYMNASIUM UNTERFÖHRING



Project information

Architect:	FELIX+JONAS ARCHITEKTEN
City:	85774 Unterföhring / Germany

PROJECT DETAILS

Project images





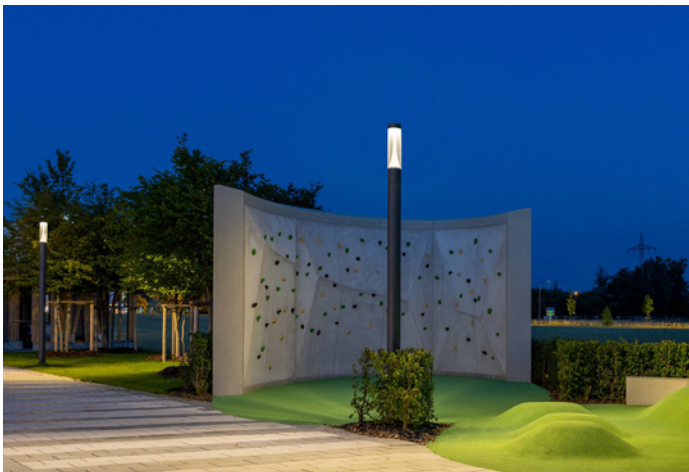
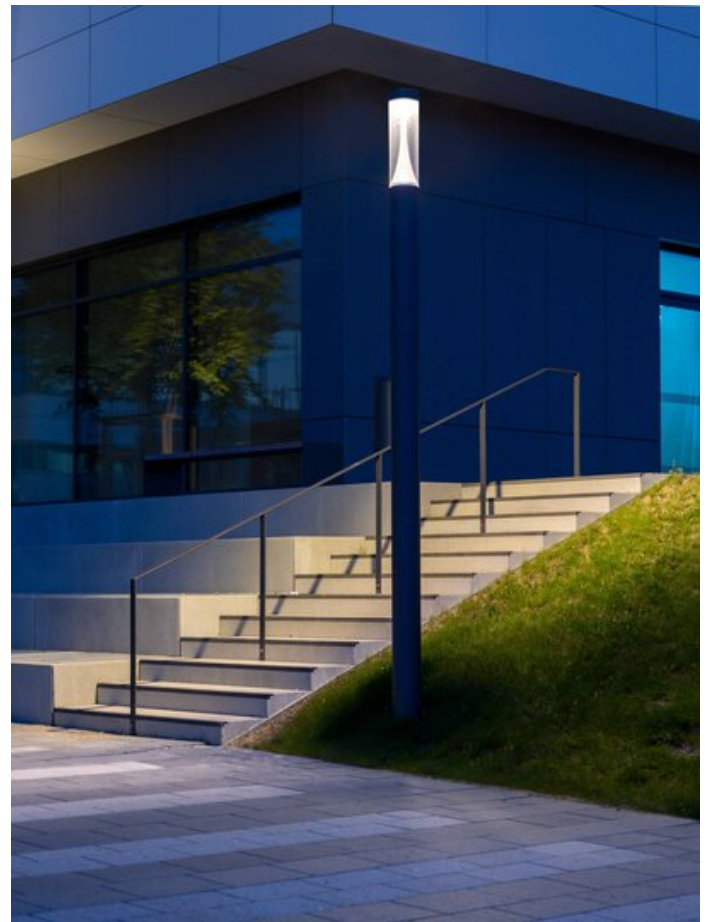

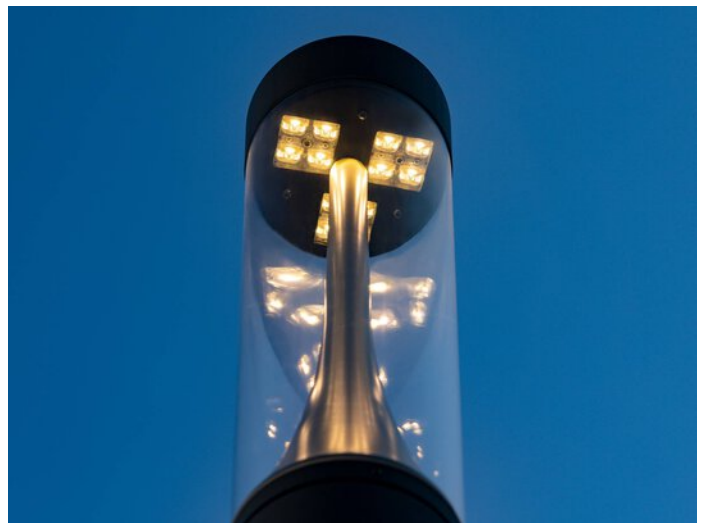
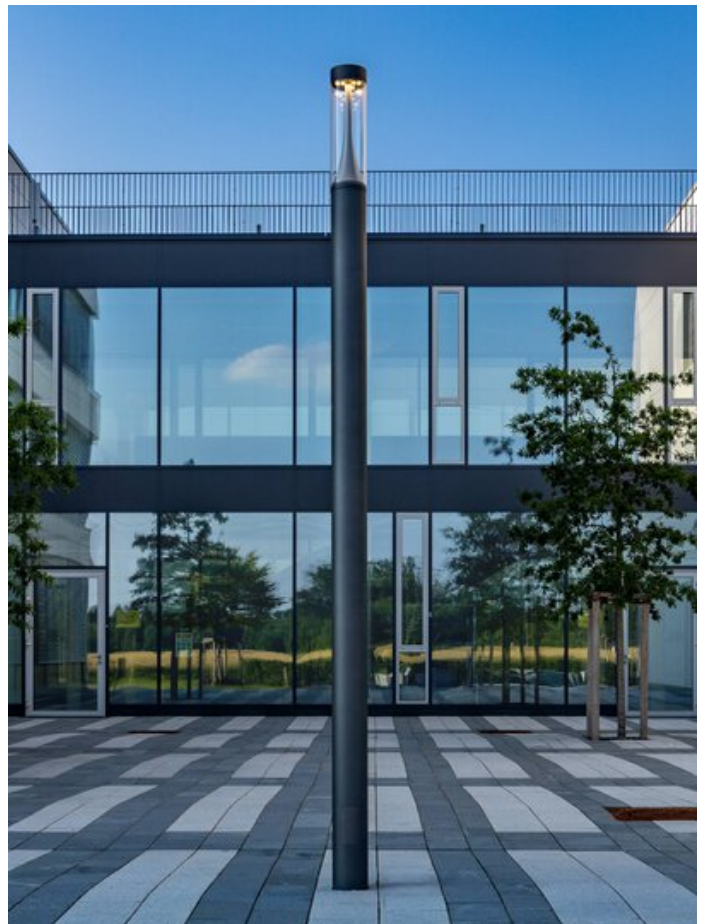

Products used



8841 LS

Constructional architecture does not stop with the outer facade but continues with the building surroundings. During daytime the new TRILUX LED bollard luminaire 8841 emphasises the design of the outdoor area, while during twilight and in the evening its excellent illumination guides the way. Whether with asymmetric or rotationally symmetric wide light distribution, the LED bollard luminaire guarantees optimal light effects with all luminaire versions. Additional protection from vandalism is provided by the possibility of a supporting column with continuous underground support.
