

AROUND THE BUILDING

KUVIAR PATH LIGHTING



Kuviar Path Lighting

Luminaire type

Bracket-mounted luminaire with flat cover.

Applications

Collection roads, Residential roads, Low-traffic roads, Pedestrian zones, Arcades, Passages, Paths in parks and green areas, Residential facilities, Stairs, Access areas, Car parks, Works roads.

Mounting methods

Bracket-mounted luminaire for mast spigot Ø 76 mm. Inclination angle for bracket mounting.

Optical system

With symmetrical wide light intensity distribution. Optical system with Multi-Lens Technology. With toughened glass, clear.

LED system

Luminaire luminous flux 2000 / 4000 / 6000 / 9000 Lm, connected load 20/40 /60/90 W, luminous efficiency of luminaire 100 lm/W. Ra > 80. Service Life : 50,000 hrs.

Luminaire body

The modular luminaire consists of the basis module and optical module. The mechanical and electrical connection of the modules is achieved without use of tools. Luminaire body of die-cast aluminium. Colour anthracite

Electrical connection

With 3-pole terminal.

Electrical version

With Electronic Switchable.

External Surge Protection Device 10 KV.

POE compatible version on request.

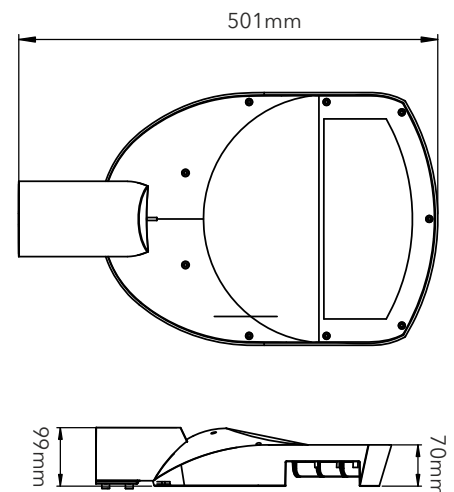

VARIANTS

10141415	LSL 2500- ET	20 W Path Light, Electronic Switchable
10141416	LSL 4000- ET	40 W Path Light, Electronic Switchable
10141417	LSL 6000- ET	60 W Path Light, Electronic Switchable
10141418	LSL 9000- ET	90 W Path Light, Electronic Switchable